

SINGLE-ARM ELEVATOR LINK

- Standard: API Spec 8C, GB/T19190
- Adopts high-quality structural alloy steel as raw material
- Safety Factor: $n=2.25 \sim 3$
- Working Load Limit: 50 ~ 750 tons
- Both ends are shaped by die forging process, the pole is pulled by free forging.
- Special heat treatment.
- Non-destructive test is performed.
- Its strength is verified throughout 1.5 WLL tensile test.
- There are signs such as WORKING LOAD LIMIT marked on the link.
- Surface painted.
- It is applicable for drilling in deep well and super-deep well.
- Use in couple.

Art. No.	D (mm)	r1 (mm)	R1 (mm)	L1 (mm)	L2 (mm)	L3 (mm)	r2 (mm)	R2 (mm)	L4 (mm)	L5 (mm)	L6 (mm)	L (mm)	Weight (kg/Pair)
DH50	48	22	51	20	100	150	22	64	60	120	180	1100	58
DH75	53	21	53	20	106	150	28	80	70	140	203	1500	90
DH100	60	22	51	20	102	150	28	64	80	140	190	1500	118
DH150	68	23	51	25	102	150	28	64	95	140	210	1800	165
DH250	78	30	70	30	140	200	34.5	102	135	203	250	2700	346
DH350	89	37	70	35	140	203	34.5	102	135	203	254	3300	462
DH500	115	47	83	50	170	250	47	121	160	242	300	3600	890
DH750	140	56	127	55	190	318	63	131	190	262	330	3660	1400

DOUBLE-ARM ELEVATOR LINK

- Standard: API Spec 8C, GB/T19190
- Adopts high-quality structural alloy steel as raw material
- Safety Factor: $n=3$
- Working Load Limit: 30 ~ 150 USton
- Manufactured by forging and welding
- Special heat treatment
- Non-destructive test is performed.
- Its strength is verified throughout 1.5 WLL tensile test.
- There are signs such as WORKING LOAD LIMIT marked on the link.
- Surface painted.
- It is applicable for drilling operation for fleet well and repairing well.
- Use in couple.

Art. No.	d1 (mm)	r1 (mm)	R1 (mm)	L1 (mm)	L2 (mm)	d2 (mm)	r2 (mm)	R2 (mm)	L3 (mm)	L4 (mm)	L (mm)	Weight (kg/Pair)
SH30	40	20	51	20	102	40	20	51	102	40	1100	53
SH50	45	22.5	51	20	102	53	22	64	128	60	1100	73
SH65	50	25	51	20	102	55	22	64	128	60	1200	94
SH75	50	25	60	20	120	60	25	80	160	70	1500	134
SH100	55	27.5	60	25	120	65	27	80	160	75	1500	160
SH150	65	23	60	35	120	75	28	85	170	94	1700	244

SWIVEL BAIL

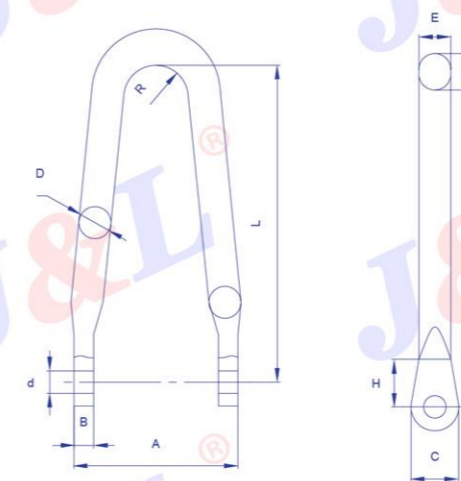

- Standard: API Spec 8C
- Adopts high-quality structural alloy steel as raw material.
- Safety Factor: $n=2.25 \sim 3$
- Working Load Limit: 135 ~ 450 ton
- Swivel bail is manufactured by free forging.
- Special heat treatment
- Non-destructive test is performed.
- Its strength is verified throughout 1.5 WLL tensile test
- There are signs such as WORKING LOAD LIMIT marked on the link.
- Surface painted.
- Match with water faucet.

Art. No.	D (mm)	A (mm)	B (mm)	C (mm)	d (mm)	E (mm)	F (mm)	H (mm)	R (mm)	L (mm)	Weight (kg)
SL135	114	585	70	170	80	114	130	170	115	1130	220
SL225	120	680	90	240	90	120	180	250	115	1300	340
SL450	140	941	120	330	130	165	225	340	115	1480	530