

大型钢丝绳制造  
LARGE SIZE STEEL WIRE ROPE FACTORY



东②门



河北省科学技术成果

证书

河北省科学技术厅

成果名称: 建筑结构用特-55级-高合钢主合金钢  
高丝索

成果水平: 国内领先

完成单位: 北方重工股份有限公司

完成人: 张 社 李彦芳 姜广峰 宋永刚  
时伟 郝建刚 和国栋 朱立平  
王春雷 高洪刚 崔海静 王同会  
冯军强 曹文忠 张德成

项目编号: 30122669



二〇一二年十一月



## ADVANTAGES

- 1. Excellent corrosion resistance due to the galfan coating, which is 2-3time of normal galvanizing.
- 2. Self-compacting and with its metallic texture, it can well matched with the structures.

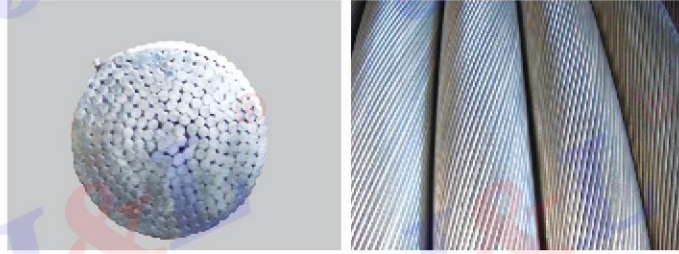

- 3. The twist angel is  $8^{\circ} \sim 12^{\circ}$ , torque balanced due to cross laying.

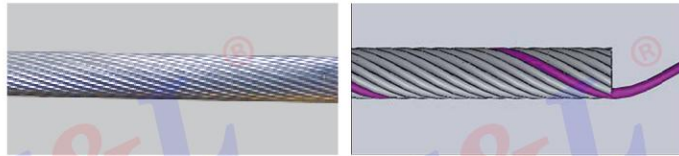

- 4. Good clamping capabilities.



- 5. Without HDPE coating, the spiral strand cable is good in fireproofing.



## PRODUCTION CAPACITY

KS8/2500, the biggest cabling machine in China, it is used for the production of large diameter, long length and super heavy steel wire ropes with maximum capacity of 350t. With the most baskets, the stranding machine of KGT72/630 is mostly used for production of line contact wire ropes and large diameter spiral strands.



Factory view



socketing platform



stranding



wire factory



stranding machine



## PRODUCTION PROCESS



## PROPERTIES OF SPIRAL STRAND

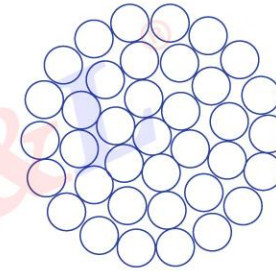

cross section diagram

Nominal Diameter (mm)	Nominal Metallic Cross Section (mm <sup>2</sup> )	Minimum Breaking Load (kn)		Nominal Metallic Mass (kg/100m)	Modulus Of Elasticity
		1670MPa	1770MPa		
Φ20	233	343	363	193	150±10GPa
Φ22	282	415	439	234	
Φ26	394	578	613	327	
Φ30	522	767	814	434	
Φ32	594	872	926	493	
Φ36	752	1104	1170	624	
Φ40	929	1363	1450	771	
Φ44	1120	1649	1750	933	
Φ48	1340	1962	2080	1110	
Φ50	1450	2129	2260	1200	
Φ52	1570	2303	2440	1300	
Φ56	1820	2671	2840	1510	
Φ58	1950	2865	3040	1620	
Φ60	2090	3066	3250	1730	
Φ62	2230	3274	3480	1850	

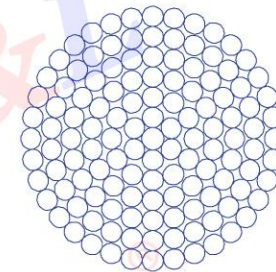

cross section diagram

Nominal Diameter (mm)	Nominal Metallic Cross Section (mm <sup>2</sup> )	Minimum Breaking Load (kn)		Nominal Metallic Mass (kg/100m)	Modulus Of Elasticity
		1670MPa	1770MPa		
Φ66	2530	3710	3940	2100	150±10GPa
Φ70	2840	4173	4430	2360	
Φ74	3180	4664	4950	2640	
Φ78	3530	5182	5500	2930	
Φ80	3710	5451	5790	3080	
Φ84	4100	6010	6380	3400	
Φ88	4490	6596	7000	3730	
Φ90	4700	6899	7320	3900	
Φ94	5130	7526	7990	4260	
Φ98	5570	8180	8680	4630	
Φ100	5800	8517	9040	4820	
Φ104	6280	9212	9780	5210	
Φ108	6770	9934	10500	5620	
Φ110	7020	10306	10900	5830	
Φ114	7540	11069	11700	6260	
Φ118	8080	11859	12600	6710	
Φ120	8360	12264	13000	6940	
Φ124	8920	13096	13900	7410	
Φ128	9510	13954	14800	7890	
Φ130	9810	14394	15300	8140	
Φ134	10400	15293	16200	8650	
Φ138	11100	16220	17200	9170	
Φ140	11400	16693	17700	9440	



## UT TYPE SWAGED CABLE

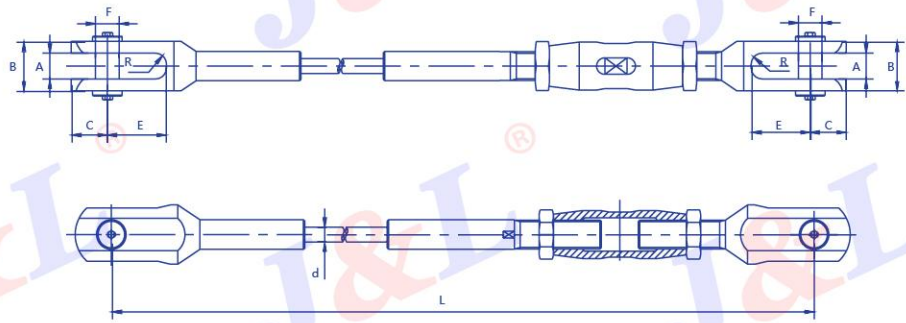

Art. No	Diameter d (mm)	Internal Opening A (mm)	External Opening B (mm)	Front End Of Ear Plate C (mm)	Depth Of Fork E (mm)	Pin Diameter F (mm)	Adjustment T (mm)
GFYC20	20	35	67	50	75	32	50
GFYC22	22	40	75	55	80	35	50
GFYC26	26	50	95	65	95	41	50

- Note: 1. The MBL of cable assembly shall be not less than the 90% of the spiral strand MBL.  
2. the opening(A) and adjustment(T) of the fork end can be changed according to the project requirements.

## W TYPE SWAGED CABLE

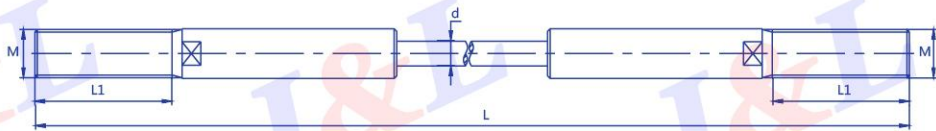

Art. No	Diameter d (mm)	External Thread M (mm)	Thread Length L1 (mm)
GFYG20	20	42	130
GFYG22	22	45	135
GFYG26	26	52	140

- Note: 1. The MBL of cable assembly shall be not less than the 90% of the spiral strand MBL.  
2. the thread length(L1) can be changed according to the project requirements.

## CABLE WITH ADJUSTABLE FORK SOCKET

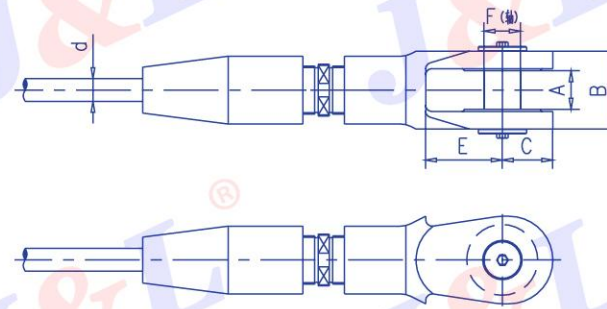

Art.No	Diameter d (mm)	Internal Opening A (mm)	External Opening B (mm)	Front End Of Ear Plate C (mm)	Depth Of Fork E (mm)	Pin Diameter F (mm)	Adjustment T (mm)	Breaking Load P (1670MPa) (KN)
JLCT30	Φ30	50	92	57	85	45	±50	767
JLCT32	Φ32	52	96	61	90	48	±50	872
JLCT36	Φ36	58	112	66	100	54	±50	1104
JLCT40	Φ40	60	120	73	110	62	±50	1363
JLCT44	Φ44	65	130	80	120	67	±50	1649
JLCT48	Φ48	70	140	87	125	73	±50	1962
JLCT50	Φ50	74	148	90	135	75	±80	2129
JLCT52	Φ52	74	150	94	140	78	±80	2303
JLCT56	Φ56	78	158	101	150	83	±80	2671
JLCT58	Φ58	80	165	105	160	88	±80	2865
JLCT60	Φ60	82	170	109	170	92	±80	3066
JLCT62	Φ62	85	175	115	175	95	±80	3274
JLCT66	Φ66	87	180	120	180	99	±80	3710
JLCT70	Φ70	93	190	128	185	105	±80	4173
JLCT74	Φ74	98	205	131	190	108	±80	4664
JLCT78	Φ78	105	215	142	195	118	±80	5182
JLCT80	Φ80	115	225	150	200	125	±100	5451
JLCT84	Φ84	125	240	155	210	127	±100	6010
JLCT88	Φ88	130	258	157	210	132	±100	6596
JLCT90	Φ90	130	260	160	220	135	±100	6899
JLCT94	Φ94	135	270	170	230	145	±100	7526
JLCT98	Φ98	150	290	180	240	155	±100	8180
JLCT100	Φ100	155	295	185	240	155	±100	8517
JLCT104	Φ104	160	305	190	260	158	±100	9212
JLCT108	Φ108	168	314	202	270	167	±100	9668
JLCT110	Φ110	170	316	210	280	175	±150	10306
JLCT114	Φ114	175	325	220	290	183	±150	11069
JLCT118	Φ118	180	340	224	290	188	±150	11859
JLCT120	Φ120	185	355	224	290	188	±150	12264
JLCT124	Φ124	185	360	230	300	197	±150	13096
JLCT128	Φ128	190	375	235	310	204	±150	13954
JLCT130	Φ130	190	380	240	320	204	±150	14394
JLCT134	Φ134	200	390	252	330	218	±150	15293
JLCT138	Φ138	205	400	262	340	225	±150	16220
JLCT140	Φ140	210	405	268	350	228	±150	16693

- Note: 1. The MBL of cable assembly shall be not less than the 90% of the spiral strand MBL.  
2. the opening(A) and adjustment(T) of the fork end can be changed according to the project requirements.  
3. please contact us if the diameter bigger than 140mm.

# CABLE WITH FORK SOCKET

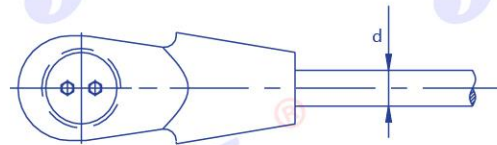
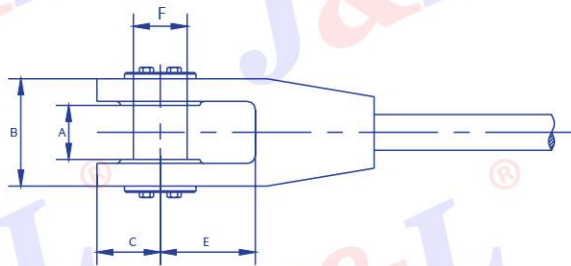

Art.No	Diameter d (mm)	Internal Opening A (mm)	External Opening B (mm)	Front End Of Ear Plate C (mm)	Depth Of Fork E (mm)	Pin Diameter F (mm)	Breaking Load P (1670MPa) (KN)
JLCG30	Φ30	50	92	57	85	45	767
JLCG32	Φ32	52	96	61	90	48	872
JLCG36	Φ36	58	112	66	100	54	1104
JLCG40	Φ40	60	120	73	110	62	1363
JLCG44	Φ44	65	130	80	120	67	1649
JLCG48	Φ48	70	140	87	125	73	1962
JLCG50	Φ50	74	148	90	135	75	2129
JLCG52	Φ52	74	150	94	140	78	2303
JLCG56	Φ56	78	158	101	150	83	2671
JLCG58	Φ58	80	165	105	160	88	2865
JLCG60	Φ60	82	170	109	170	92	3066
JLCG62	Φ62	85	175	115	175	95	3274
JLCG66	Φ66	87	180	120	180	99	3710
JLCG70	Φ70	93	190	128	185	105	4173
JLCG74	Φ74	98	205	131	190	108	4664
JLCG78	Φ78	105	215	142	195	118	5182
JLCG80	Φ80	115	225	150	200	125	5451
JLCG84	Φ84	125	240	155	210	127	6010
JLCG88	Φ88	130	258	157	210	132	6596
JLCG90	Φ90	130	260	160	220	135	6899
JLCG94	Φ94	135	270	170	230	145	7526
JLCG98	Φ98	150	290	180	240	155	8180
JLCG100	Φ100	155	295	185	240	155	8517
JLCT104	Φ104	160	305	190	260	158	9212
JLCT108	Φ108	168	314	202	270	167	9668
JLCT110	Φ110	170	316	210	280	175	10306
JLCT114	Φ114	175	325	220	290	183	11069
JLCG118	Φ118	180	340	224	290	188	11859
JLCG120	Φ120	185	355	224	290	188	12264
JLCG124	Φ124	185	360	230	300	197	13096
JLCG128	Φ128	190	375	235	310	204	13954
JLCG130	Φ130	190	380	240	320	204	14394
JLCG134	Φ134	200	390	252	330	218	15293
JLCG138	Φ138	205	400	262	340	225	16220
JLCG140	Φ140	210	405	268	350	228	16693

Note: 1. The MBL of cable assembly shall not less than the 90% of the spiral strand MBL.

2. the opening(A) and adjustment(T) of the fork end can be changed according to the project requirements.

3. please contact us if the diameter bigger than 140mm.