



PPWS FOR SUSPENSION BRIDGE MAIN CABLES

- Comply with standard JT/T395-1999.
- Apply to main cable of suspension bridge

$\Phi 5\text{mm}, \sigma_b \geq 1670\text{MPa}$

D1 : Max. diameter of wire bundle
H : Wire bundle height

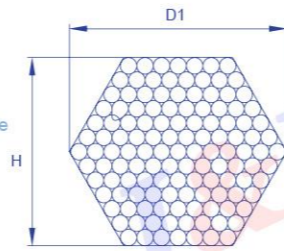

Specification	Max. diameter of wire bundle D1 (mm)	Wire Bundle Height H (mm)	Nominal Metallic Cross Section S (mm ²)	Nominal Metallic Mass (kg/m)	Breaking Load (kN)
5X61	46	40	1198	9.4	2000
5X91	56	48	1787	14.0	2984
5X127	66	57	2494	19.6	4164
5X169	75	66	3318	26.0	5542

SOCKET FOR PPWS

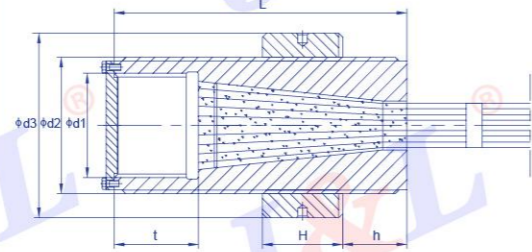

L : Socket length
H : Nut height
Φd1 : inner thread diameter
Φd2 : outer thread diameter
Φd3 : outer diameter of nut
t : inner thread length
h : Nut adjustment

Specification	L (mm)	H (mm)	t (mm)	Φd1 (mm)	Φd2 (mm)	Φd3 (mm)	h (mm)
5X61	340	75	100	Tr110X8	Tr140X6	190	83
5X91	365	100	100	Tr130X8	Tr170X8	230	83
5X127	410	120	125	Tr150X10	Tr200X10	260	83
5X169	465	120	125	Tr165X10	Tr220X10	290	110

EXTERNAL THREAD CYLINDRICAL SOCKET(JULI STANDARD)

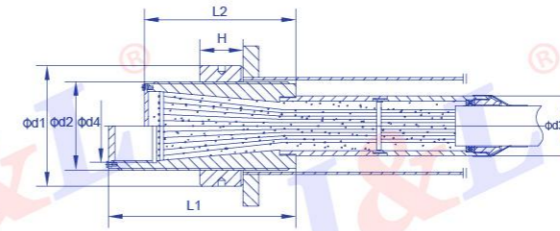
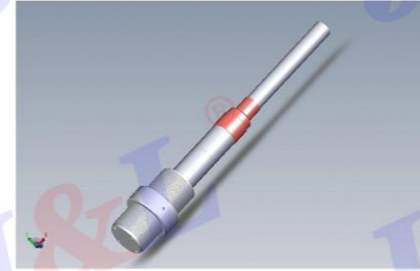

L1: Socket length of tensioning end
L2: Socket length of fixed end
H: Nut height
d1: Outer diameter of Nut
d2: External thread diameter
d3: outer diameter of connecting sleeve
d4: Internal thread diameter

Specification	L1 (mm)	L2 (mm)	H (mm)	d1 (mm)	d2 (mm)	d4 (mm)
5X55	280	240	75	190	Tr140X6	Tr110X6
5X61	340	240	75	190	Tr140X6	Tr110X8
5X73	350	280	100	210	Tr160X8	Tr120X8
5X85	350	280	100	210	Tr160X8	Tr120X8
5X91	365	295	100	230	Tr170X8	Tr130X8
5X109	390	295	120	240	Tr180X10	Tr135X10
5X121	400	305	120	250	Tr190X10	Tr140X10
5X127	410	315	120	260	Tr200X10	Tr150X10
5X139	430	325	120	270	Tr200X10	Tr150X10
5X151	440	325	120	270	Tr200X10	Tr150X12
5X163	460	345	140	280	Tr210X12	Tr155X12
5X187	470	355	140	290	Tr220X12	Tr160X12
5X199	500	360	140	300	Tr230X12	Tr165X14
5X211	500	360	140	300	Tr230X12	Tr170X14
5X223	510	370	170	310	Tr240X12	Tr175X14
5X241	530	380	170	330	Tr250X14	Tr180X14
5X253	560	390	170	340	Tr260X14	Tr190X16
5X265	570	400	170	340	Tr260X14	Tr190X16
5X283	580	410	170	350	Tr270X14	Tr200X16
5X301	590	420	190	360	Tr280X16	Tr205X16

EXTERNAL THREAD CYLINDRICAL SOCKET(JULI STANDARD)

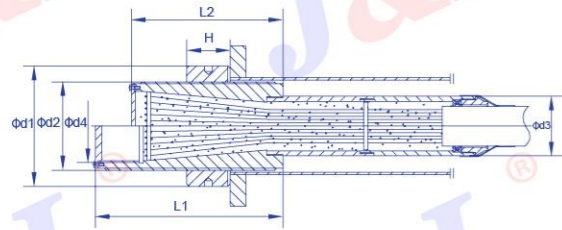

L1: Socket length of tensioning end
 L2: Socket length of fixed end
 H:Nut height
 d1:Outer diameter of Nut
 d2:External thread diameter
 d3:outer diameter of connecting sleeve
 d4:Internal thread diameter

Specification	L1 (mm)	L2 (mm)	H (mm)	d1 (mm)	d2 (mm)	d4 (mm)
7X55	385	340	80	230	Tr170X6	Tr140X6
7X61	385	340	80	230	Tr170X6	Tr140X6
7X73	400	360	100	250	Tr190X8	Tr155X6
7X85	400	360	100	250	Tr190X8	Tr155X6
7X91	440	370	100	260	Tr200X8	Tr165X8
7X109	460	390	120	290	Tr220X10	Tr180X8
7X121	510	415	120	300	Tr230X10	Tr185X10
7X127	520	425	120	310	Tr240X10	Tr195X10
7X139	520	425	120	310	Tr240X10	Tr195X10
7X151	530	435	120	330	Tr250X10	Tr195X10
7X163	550	455	120	340	Tr260X10	Tr205X10
7X187	580	485	150	350	Tr270X12	Tr215X10
7X199	620	515	150	370	Tr280X12	Tr220X10
7X211	630	525	150	380	Tr290X12	Tr230X10
7X223	640	535	150	390	Tr300X12	Tr235X10
7X241	665	545	170	400	Tr310X14	Tr240X12
7X253	700	570	170	420	Tr320X14	Tr250X12
7X265	700	570	170	420	Tr320X14	Tr260X12
7X283	730	590	170	430	Tr330X14	Tr265X14
7X301	750	610	190	440	Tr340X16	Tr270X14
7X313	795	630	190	470	Tr360X16	Tr285X16
7X337	795	630	190	470	Tr360X16	Tr285X16
7X349	815	650	190	480	Tr360X16	Tr295X15
7X367	815	650	190	480	Tr370X18	Tr295X16
7X397	865	690	220	510	Tr390X18	Tr310X16
7X421	890	720	220	520	Tr400X18	Tr320X16

EXTERNAL THREAD CYLINDRICAL SOCKET(NATIONAL STANDARD)

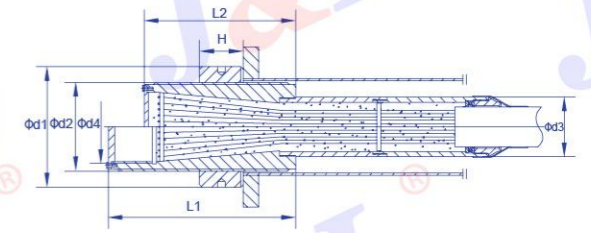

L1: Socket length of tensioning end
 L2: Socket length of fixed end
 H:Nut height
 d1:Outer diameter of Nut
 d2:External thread diameter
 d3:outer diameter of connecting sleeve
 d4:Internal thread diameter

Φ5 series

Specification	L1 (mm)	L2 (mm)	H (mm)	d1 (mm)	d2 (mm)	d3 (mm)	d4 (mm)
5X55	300	300	70	170	Tr135X6	93	Tr105X5
5X61	300	300	70	180	Tr140X6	93	Tr110X5
5X73	300	300	90	190	Tr150X8	100	Tr115X6
5X85	335	335	90	210	Tr165X8	100	Tr125X6
5X91	335	335	90	210	Tr165X8	112	Tr125X6
5X109	340	290	90	225	Tr175X8	112	Tr135X6
5X121	355	300	90	235	Tr185X8	119	Tr140X6
5X127	365	300	90	235	Tr185X8	125	Tr140X8
5X139	365	300	90	250	Tr195X8	125	Tr145X8
5X151	380	310	90	255	Tr200X8	131	Tr150X8



Chongqing Yunyang Yangtze River Bridge, this cable-stayed bridge with structure of two pylons, double cable plane, with a 637m long main bridge and 318m main span, was completed in September 2005.

The cables sizes are Φ7×73, Φ7×91, Φ7×109, Φ7×127, Φ7×139, Φ7×163, Φ7×187, Φ7×199. totally 120pcs, 1040.93ton for the wire. The cable strands were coated by an extruded double layer HDPE sheath (black+orange).

EXTERNAL THREAD CYLINDRICAL SOCKET(NATIONAL STANDARD)

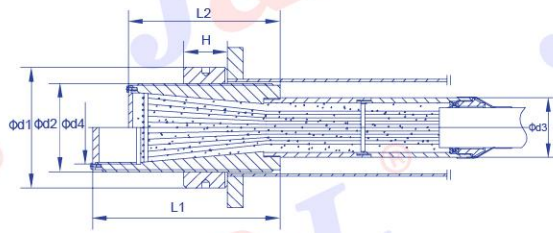

L1: Socket length of tensioning end
 L2: Socket length of fixed end
 H: Nut height
 d1: Outer diameter of Nut
 d2: External thread diameter
 d3: outer diameter of connecting sleeve
 d4: Internal thread diameter

Φ7 series

Specification	L1 (mm)	L2 (mm)	H (mm)	d1 (mm)	d2 (mm)	d3 (mm)	d4 (mm)
7X55	350	295	90	220	Tr175X8	119	Tr130X8
7X61	360	295	90	230	Tr180X8	119	Tr135X8
7X73	370	295	90	250	Tr190X8	125	Tr140X8
7X85	410	325	110	270	Tr205X10	131	Tr150X8
7X91	410	325	110	275	Tr210X10	138	Tr155X8
7X109	430	335	110	295	Tr225X10	138	Tr165X10
7X121	450	345	135	310	Tr240X12	144	Tr175X10
7X127	450	340	135	320	Tr245X12	150	Tr180X10
7X139	460	335	135	325	Tr250X12	157	Tr180X12
7X151	480	355	135	340	Tr265X12	157	Tr190X12
7X163	510	375	135	350	Tr270X12	166	Tr195X12
7X187	520	375	155	375	Tr285X12	166	Tr205X12
7X199	540	395	155	385	Tr300X14	178	Tr215X14
7X211	555	390	180	400	Tr310X14	178	Tr220X14
7X223	575	410	180	405	Tr315X14	192	Tr225X14
7X241	585	415	180	425	Tr330X16	192	Tr235X16
7X253	595	425	180	435	Tr335X16	192	Tr240X16
7X265	610	425	200	445	Tr345X16	192	Tr245X16
7X283	635	445	200	450	Tr345X18	201	Tr245X18
7X301	645	450	200	470	Tr360X18	217	Tr255X18
7X313	655	460	200	470	Tr365X18	217	Tr260X18
7X337	695	480	220	495	Tr385X20	243	Tr270X18
7X349	710	495	220	500	Tr385X20	271	Tr270X20
7X367	715	500	220	510	Tr390X20	271	Tr275X20
7X379	725	510	220	520	Tr400X20	287	Tr280X20
7X409	755	510	245	540	Tr415X22	290	Tr290X22
7X421	775	530	245	545	Tr420X22	295	Tr295X22